

# Sheikh Zayed National Museum

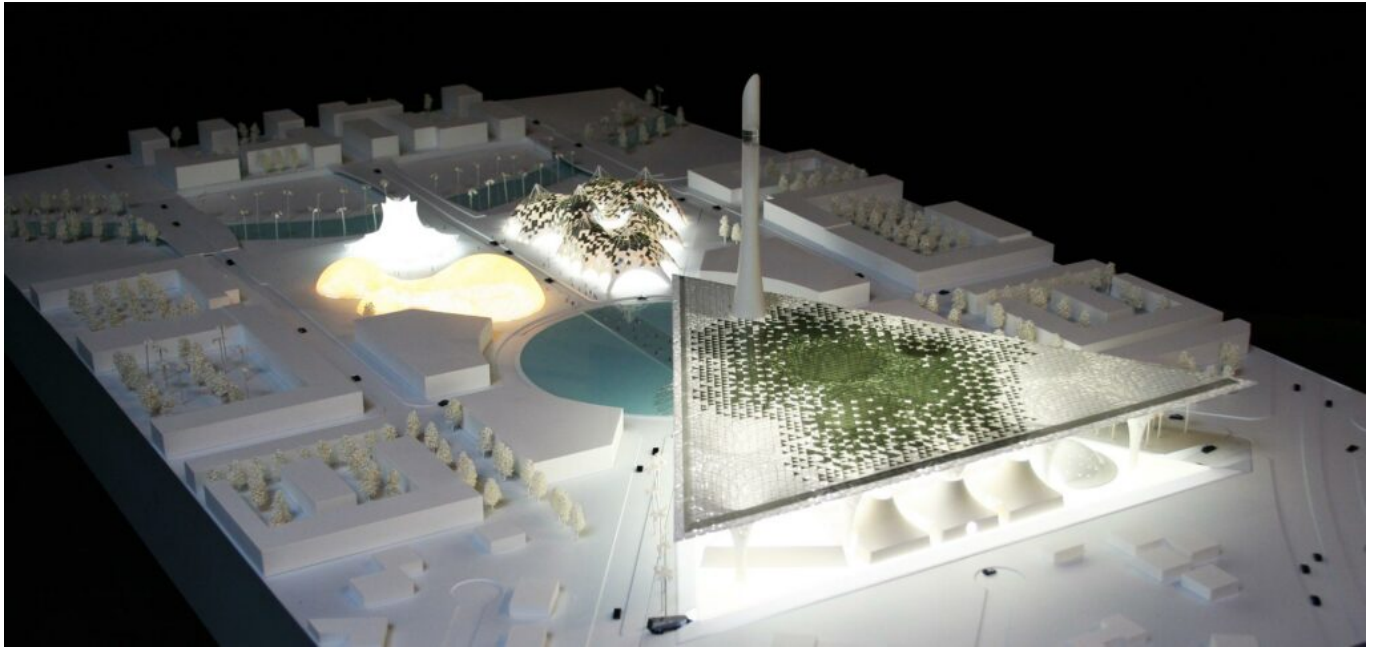

Year: 2007

Location: United Arab Emirate

Program: Museum / Gallery

Status: Competition

Type: New-built

Structure:

The Big Roof is representative of Sheikh Zayed, covering and protecting the seven emirates. The main construction material is local sand. A large circular “pond” sits in front of the museum. It is divided through the centre by a bridge, which provides a connection with the entrance. The crossing will be made of tempered glass, making the water visible below the visitor’s feet as they cross. As the water vaporizes, The “pond” also works as a natural cooling device.