

Year: 2006  
Location: United States  
Program: House

# Residence in East Hampton

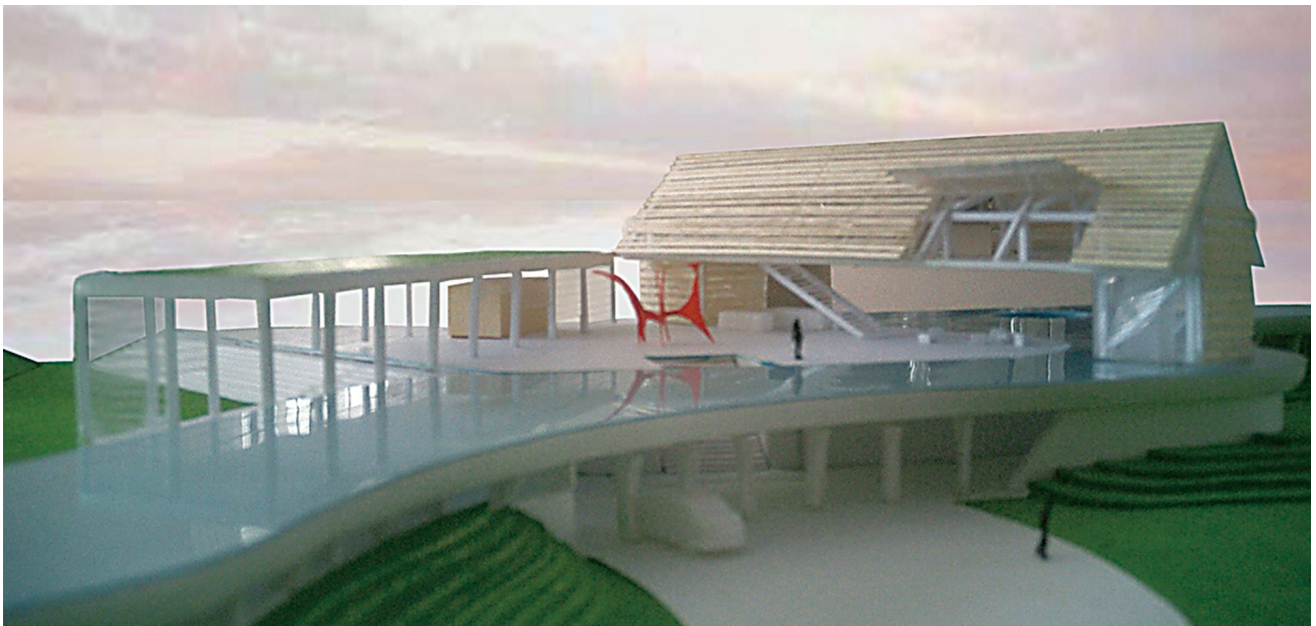

This residence is designed to meet the special conditions of its vast, undulating site opening up to the Atlantic Ocean. Therefore the first floor outline follows the topographic contour of the site, and the second floor features a pool, of which the water surface creates a visual continuity to the ocean. The third floor is lifted up particularly high in the site to obtain extensive views.