

Year: 2016

Location: Japan

Program: Culture and Leisure, Museum / Gallery

# Osaka New Art Museum

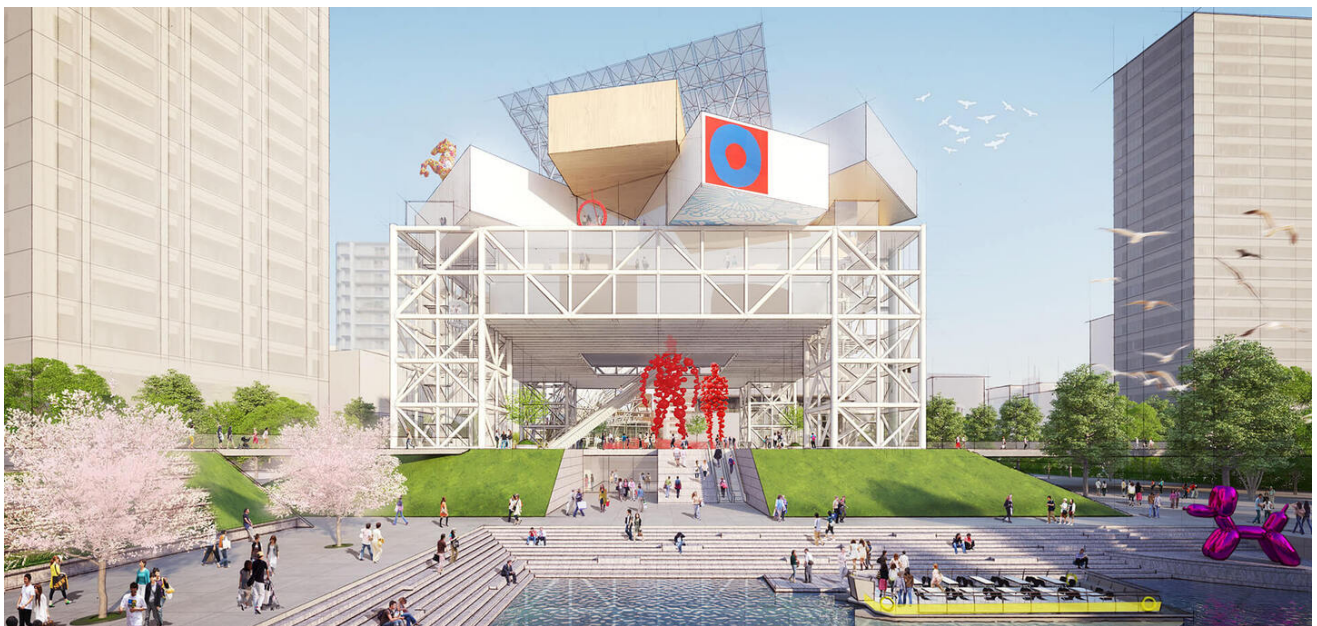

This art museum is located at Nakanoshima close to the National Museum of Art, Osaka. Not only the remains of the boat entrance are restored at the site, but also pleasure boats can approach there as a symbol of the water city Osaka. As for the building, the upper volumes are raised up 15m by steel truss and the space below is opened to the people as an event plaza. The administrative section, research section and art storage are inserted in the truss space, and box shape galleries are stacked above them. Gaps between the galleries offer a picture window which projects Osaka's cityscape.