

Year: 2019

Location: France

Program:

Grand Palais Éphémère

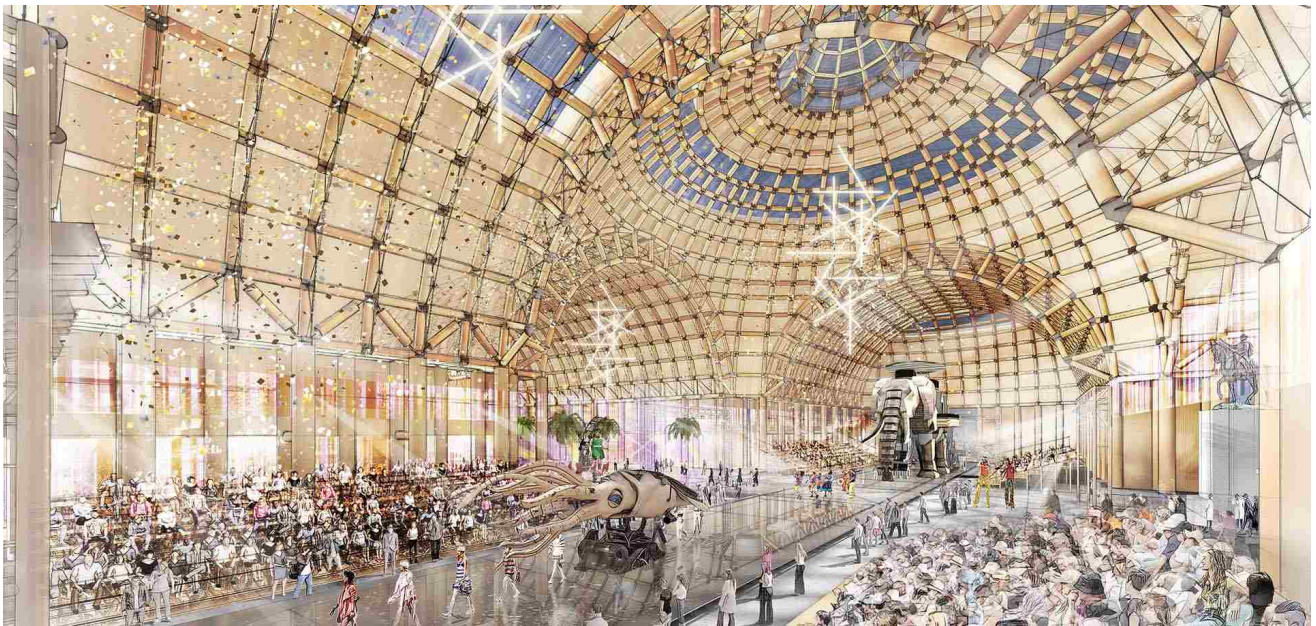

The Grand Palais is a historic exhibition hall and art museum built in 1900 in Champs-Élysées, in the center of Paris, and this is a competition proposal for a temporary exhibition hall to be built in front of the Eiffel Tower while it undergoes renovations. Our proposal was to accurately reenact the proportions of the original Grand Palais using a paper tube structure. Special attention was paid to the composition of the facade and roof due to the very strict acoustic requirements. The structure was modularized so that the structure could be reassembled in various other configurations.